

Mobile Wire Shelving

Assembly Instructions



PARTS LIST

4 Posts

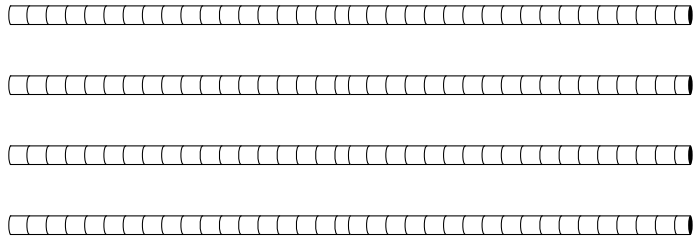

16 Shelf Clips

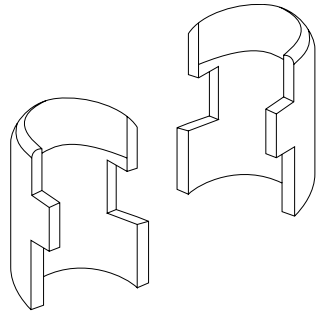

4 Shelves

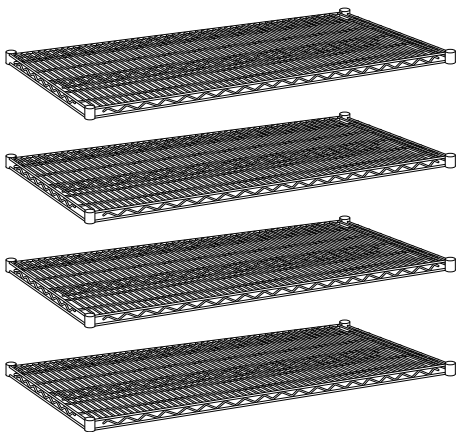

*4 Casters

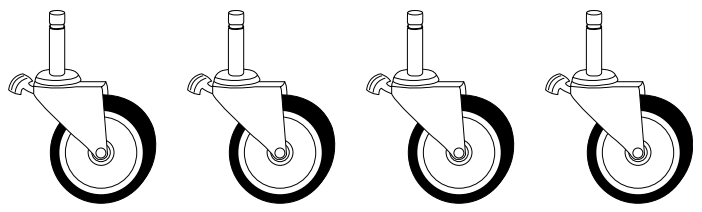

** casters for mobile units*

GENERAL SAFETY INFORMATION

Use two people when setting up this unit. Some parts may have sharp edges. Care must be taken when handling various pieces to avoid injury. For safety, wear a pair of work gloves when assembling or performing any maintenance.

STEP 1: Attaching Casters to Posts

1. Components: 4 posts and 4 caster wheels
2. Tighten the nut at the top of the caster to expand the rubber boot insuring a snug fit in the post. **See Figure A.**
3. Using only your hands, gently press and turn caster into bottom of each post until seated securely. **See Figure B.**
4. **DO NOT HAMMER THE CASTER INTO THE POST OR DAMAGE WILL OCCUR.** **See Figure C.**

Figure A



STEP 2: Attaching Clips for Bottom Shelf

1. Components: 4 posts from Step 1 and 4 clips (8 halves).
2. Attach a 2 piece clip at the desired location at the bottom of the posts. Be sure that the small end of the clip is pointing in the upward direction. The ridge inside of the clip should be aligned with the groove in the pole. Snap clip firmly into pole. **See Figure D.**

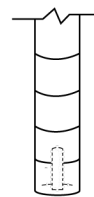

Figure B



STEP 3: Install Bottom Shelf

1. Components: 1 Shelf.
2. Place your shelf on its side. Holding the shelf, slide each pole through the shelf-cylinders starting from the top of the pole. Push each pole until the plastic clip is snug into the shelf cylinder. Note that the wire surface is on the top of the shelf. **See Figure E.**
3. To place the unit upright, hold the sides of the shelf and bring downward gently. Press firmly against shelf until shelf cylinders are firmly over the shelf clips.

STEP 4: Installing 2nd Shelf

1. Components: 1 Shelf and 4 clips per shelf.
2. Attach a two piece clip at the desired location of the posts. Be sure that the small end of the clip is pointing in the upward direction. The ridge inside of the clip should be aligned with the groove in the pole. Snap clip firmly into post.
3. Holding the shelf by its sides, slide the shelf over the posts. Push the shelf firmly downward over the shelf clips. Shelf should fit firmly over clips.

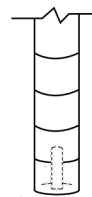

Figure C



STEP 5: Installing 3rd and 4th Shelves

1. Repeat Step 4

Final Product

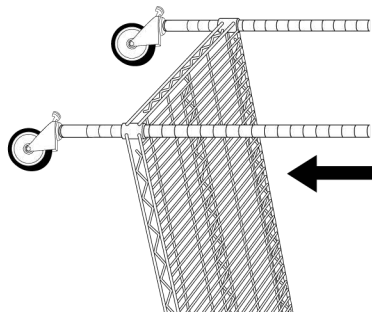
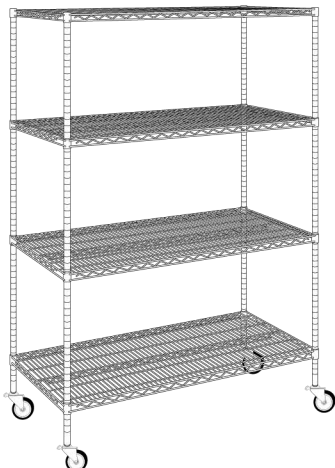

Figure E.

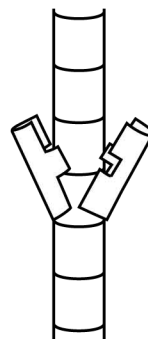

Figure D.